



FRANCE DESIGNED

Opal

Stroller

USER MANUAL

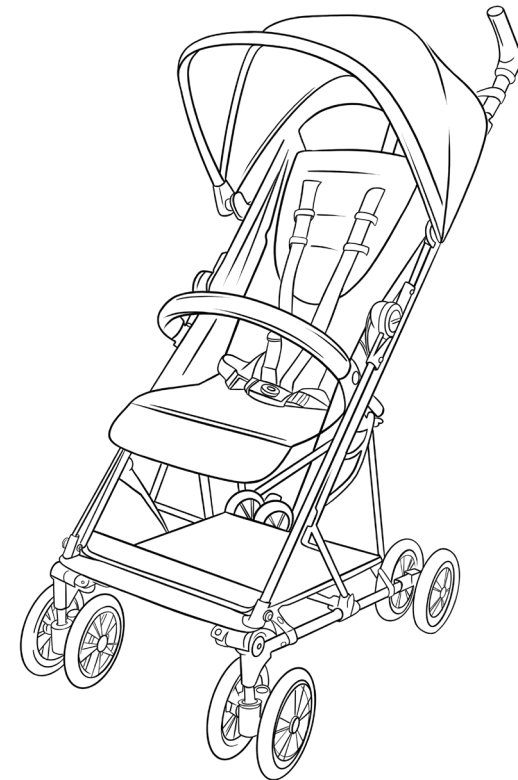

[www.jikelbaby.com](http://www.jikelbaby.com)

**IMPORTANT**

Retain for Future Reference & Read Carefully



---

## 2 360 degrees rotation handle

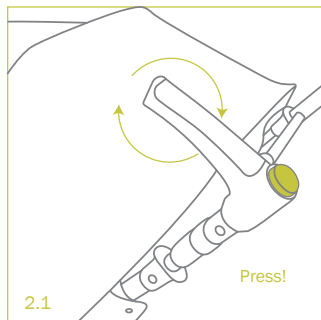

2.1 Press the button at the top of the handle and rotate the handle.

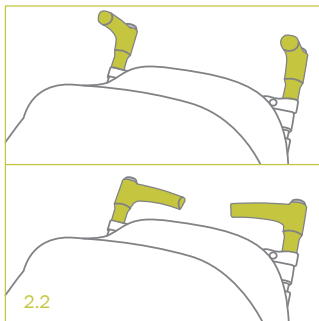

2.2-2.3 Complete handle rotation.

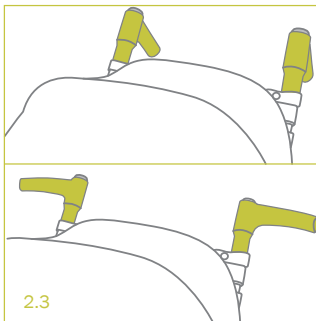

## 3 Install & Pull Out Bumper Bar

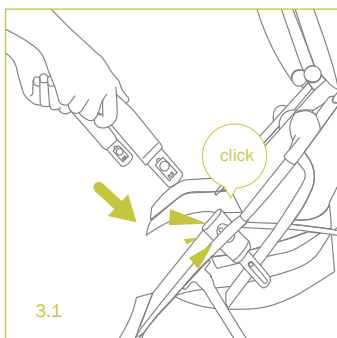

3.1 Install the Bumper bar.

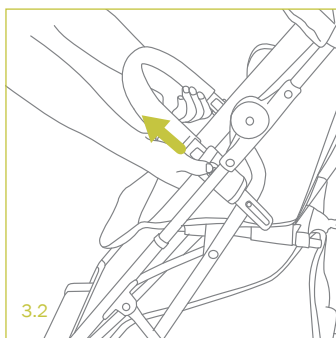

3.2 Pull out the Bumper bar.

---

#### 4 Install & Pull Out Front Wheels

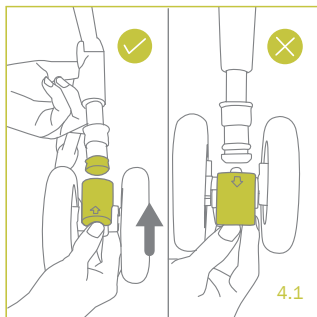

4.1 Follow the arrow upwards and align the front tube to install the front wheels.

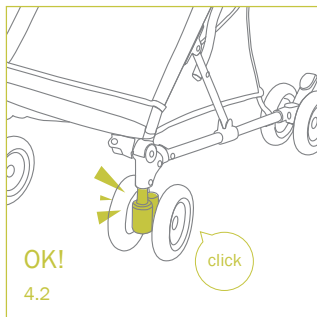

4.2 Front wheel installation is completed.

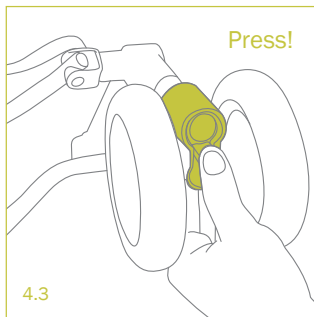

4.3 Press the front wheel release button to pull the front wheel out.

#### 5 Harness Operation

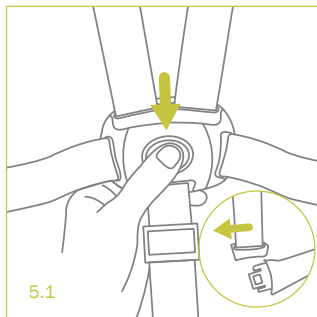

5.1 Press the middle button latch, both sides of the latch pop, you can unlock the seat belt

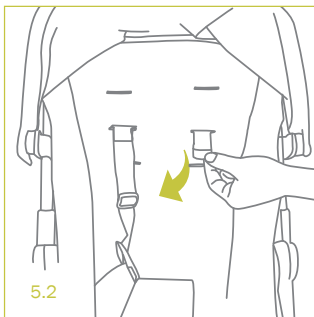

5.2 Feed the shoulder strap in the back through the most appropriate opening for child's height.

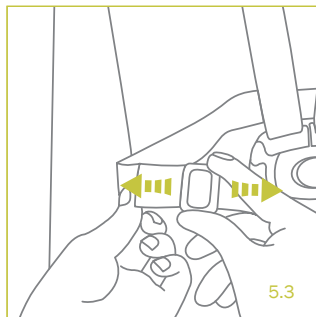

5.3 Press and hold the adjustment button to adjust the length of the seat belt.

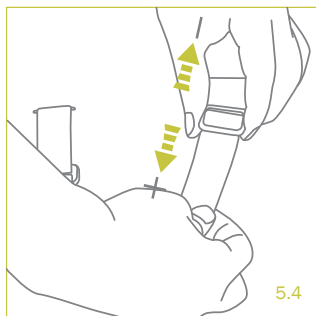

5.4 Shoulder strap length adjustment.

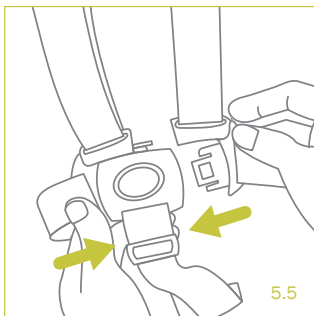

5.5 At the same time buckle the latch on waist belt.

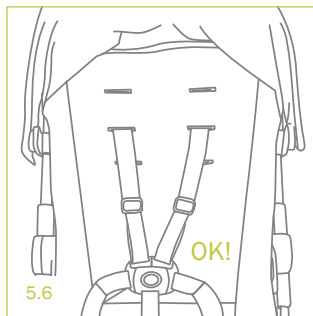

4.6 Complete shoulder strap adjustment.

## **WARNING**

**BEFORE USING THE STROLLER, THE HEIGHT OF HARNESS ON THE BACKREST SHOULD BE PROPERLY ADJUSTED ACCORDING TO THE AGE OF CHILD.**

## **Backrest Adjustment**

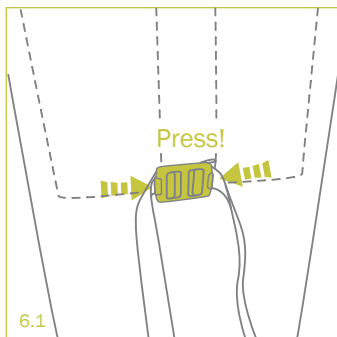

6.1 Press the back adjustment button and pull down to adjust the back.

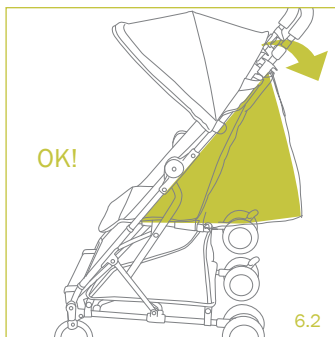

6.2 Complete back adjustment.

---

## 7 Hanging Belt Operation

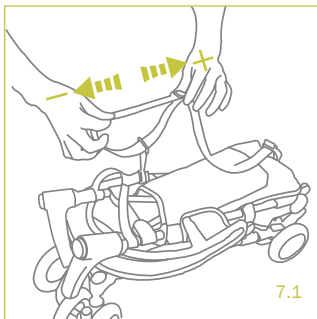

7.1 Adjust the strap length.

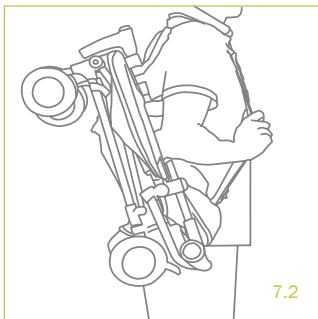

7.2 Easy to carry.

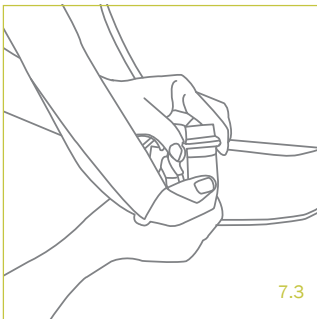

7.3 The strap is removable.

## 8 Lock / Release the brake

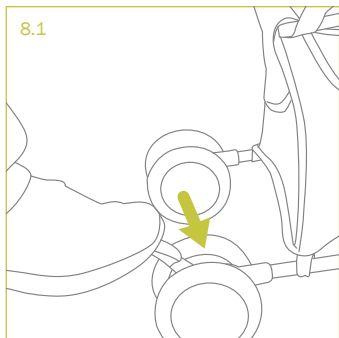

8.1 Press the brake pedestal to lock the on both sides brakes.

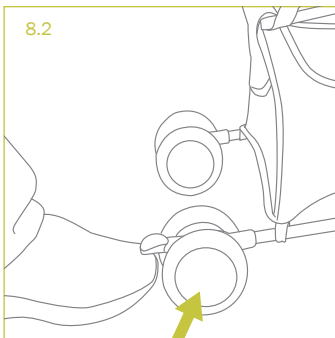

8.2 Raise the brake pedestal up and release the brakes.

---

## 9 Fold The Stroller

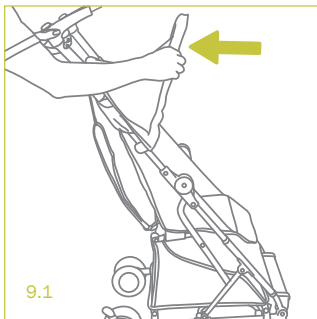

9.1 Pull back the canopy.

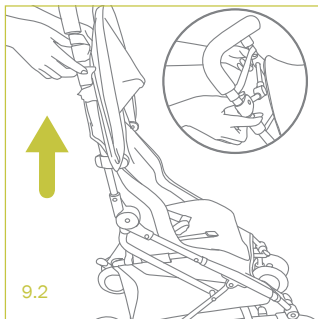

9.2 Lift up the release lever and push the handles forward.

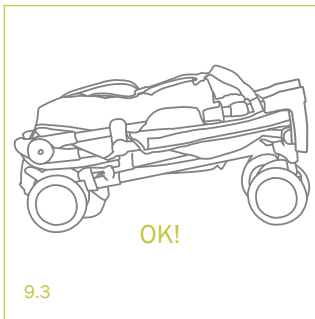

9.3 The stroller is folded completely.

## ! WARNING

DO NOT HANG ANYTHING ON THE CONNECTING ROD.

## 10 Remove Canopy and Seat Fabric

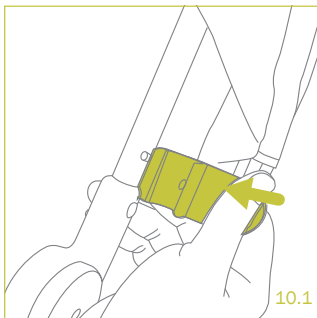

10.1 Install: Fasten the clip of the canopy to the frame tube, align the bumps on the clip to the hole on the tube.

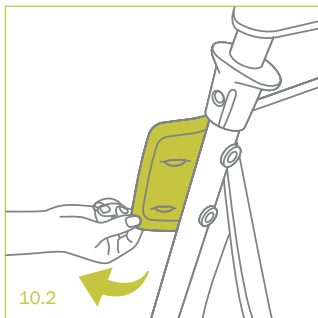

10.2 Unbuckle the seat backrest on the two sides of the handlebar.

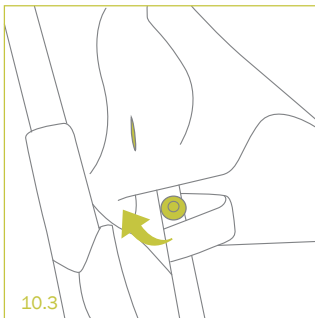

10.3 Unlock the bottom of the back.

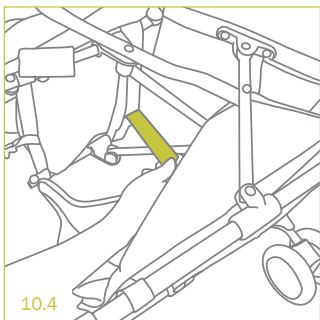

10.4 Put aside the seat of the velcro fastener.

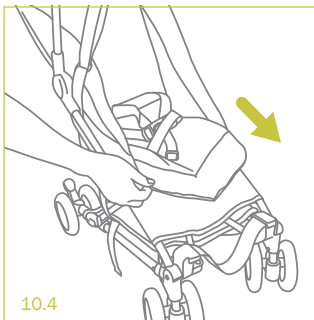

10.5 Pull forward seat fabric.

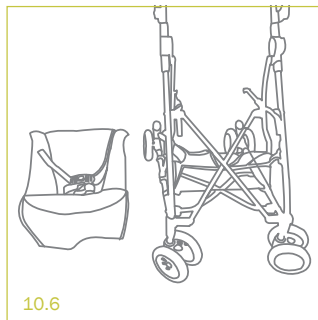

10.6 Complete the canopy and seat fabric off.

## WARNING

---

- Read these instructions carefully before use the stroller and keep the manual for future reference. Your child's safety may be affected if you do not follow these instructions.
- Never leave your child unattended.
- Ensure that all the locking devices are engaged before use.
- To avoid injury ensure that your child is kept away when unfolding and folding this product.
- Do not let your child play with this product.
- Avoid serious injury from falling or sliding out, always use the restraint system.
- Check that the pram body or seat unit attachment devices are correctly engaged before use.
- This product is not suitable for running or skating.
- This product is intended for child from 0 to 36 months of age and up to 15 kg of weight.
- The parking device shall be engaged when placing and removing the children.
- Any goods carried in the basket are not to exceed 5 kg.
- Any load attached to the handle and/of the vehicle /or on the back of the backrest and /or on the sides of the stroller affects the stability.
- This product is designed for one child only.
- The seat can only be paired with the manufacture's stroller.
- Only use the accessories supplied by manufacturer.
- Should your child need to sleep, then it should be placed in a suitable pram body, cot or bed.
- Only replacement parts supplied or recommended by the manufacturer / distributor can used.
- To prevent a possible choking hazard, remove and discard packing material before using this product.
- Do not roll the stroller on stairs or escalators with child in it.
- Do not use this product if any parts are missing or broken.
- Do not allow child to stand on the footrest. The stroller may tip over and injure child.
- Bags or heavy items hanged on the stroller may cause it unstable.
- Excessive weight may cause a hazardous unstable condition to exist.
- Accessories which are not approved by the manufacturer shall not be used.

## Cleaning And Maintenance

- This product is suitable for surface cleaning.
- Wash the fabric with cold mild soap water , and air dry.
- No bleach. Drip dry. Do not put in dryer. Do not iron or dry wet.
- Metal and plastic parts can be wiped clean and dried with a soft cloth. Do not use abrasive cleaners or solvents.
- Keep product away from direct sunlight or high temperature by storage.
- Periodically replace any damaged parts immediately, such as oil caster bolts wheels axles, or fixings to ensure brakes are secure and in full working order.



# Parts List

---

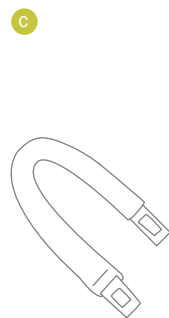
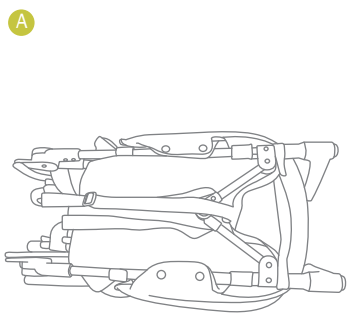

Unpack the carton, and make sure that all parts are there.  
A. Stroller frame\*1    B. Front wheels\*2    C.Bumper bar \*1

## Stroller Assembly

### 1 Unfold The Frame

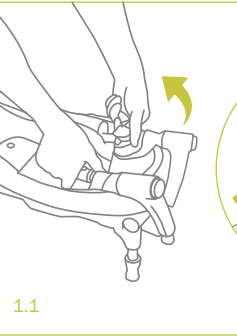

1.1 Pull the frame release lever.

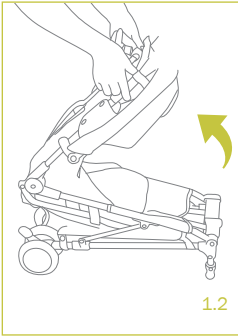

1.2 Open the frame.

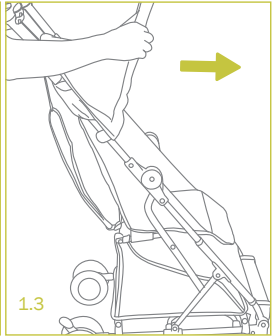

1.3 Open the Canopy.